

Version	Symbol	Type
Elbow fitting quick coupling		V44

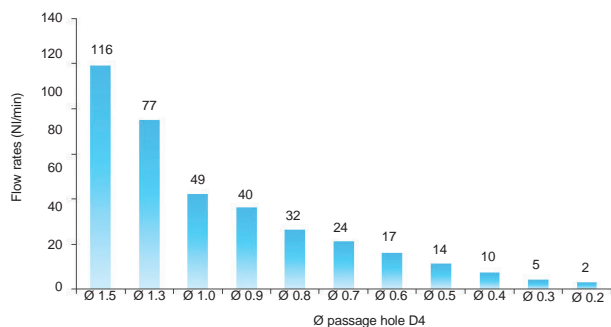

This fitting houses a cartridge with a calibrated orifice. The orifice diameter causes a flow throttling thereby allowing the desired flow (see our Chart 1). The throttle fittings are mostly used when the user knows the exact cylinder speed hand when no further settings of the cylinder are requested. The major advantage is that no undesired tamperings can occur and in case of vibrations the flow setting will remain stable.

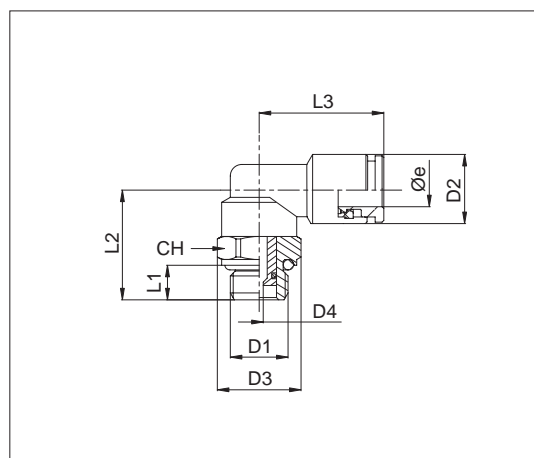

Item	Tube Ø	D1	D2	D3	D4	L1	L2	L3	CH
V44 04 M5	4	M5	9	10	...	4	11	18	13
V44 04 18	4	1/8"	9	14,5	...	5	18	19	13
V44 06 M5	6	M5	12	10	...	4	11	20,5	13
V44 06 18	6	1/8"	12	14,5	...	5	18	21,5	13
V44 06 14	6	1/4"	12	16	...	6,5	21,5	21,5	13
V44 08 18	8	1/8"	14	14,5	...	5	18	22	13
V44 08 14	8	1/4"	14	16	...	6,5	21,5	22	13

When ordering please specify right after the article code the diameter of the calibrated hole (D4) required.  
Example: V44 06 18 0,3

Technical data	
Fluid	Compressed air
Pressure range	Max. inlet 10 bar; Setting performance 0 ÷ 8 bar
Temperature range	0 °C ÷ + 70°C
Parallel threads	UNI - ISO 228 / 1 (BSP)
Metric threads	ISO R / 262
Flow rate at 6 bar (NI/min)	1/8" = 340 - 1/4" = 580
Materials	Body: Nickel plated brass Spring: Stainless steel AISI 302 Seals: Nitrile rubber (NBR)