

# Valves series A1

1/2", 3/2, pneumatically operated



Standard executions			
Version	Symbol	Code	Item
3/2 NC		034116	A1P430
3/2 NO		034127	A1P431
3/2 pilot/pilot		034128	A1P432



Series of spool valves, with static seals, high flow, for panel mounting.

**CE** **II 2Gc IIB T5**  
**II 2Dc T100°C**

On request, they can be supplied according to 2014/34/EU - **ATEX**

### Code key

Series	Actuation	Size	Function
A1	P = pneumatic	4 = 1/2"	30 = 3/2 NC 31 = 3/2 NO 32 = 3/2 pilot/pilot 33 = 3/2 pilot/pilot differential

2

Technical data			
Fluid	Compressed filtered air with or without lubrication. Lubrication, if started, must be continued.		
Pressure range	0 ÷ 10 bar		
Temperature range	-10°C ÷ +60°C		
Orifice	15 mm		
Flow	2900 NI/min at 6 bar with ΔP 1 bar		
Minimum piloting pressure	Spring return: 2,5 bar	Bistable: 1 bar	3 positions: 2,5 bar
Mounting	In any position		
Manual override	Spring return on valve body		
Materials	Body:	Anodised aluminium	
	Covers:	Anodised aluminium	
	Spool:	Hard aluminium anodized	
	Distancers:	Aluminium	
	Seals:	Hydrogenated Nitrile Butadiene Rubber (HNBR)	

Valves series A1  
1/2", 3/2, pneumatically operated

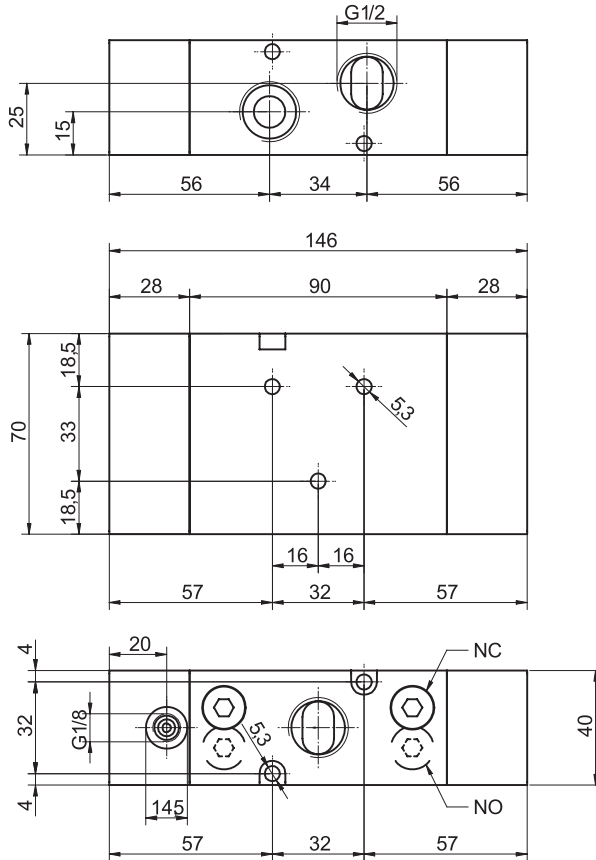

Version	Symbol	Code	Item
3/2 NC		034116	A1P430
3/2 NO		034127	A1P431

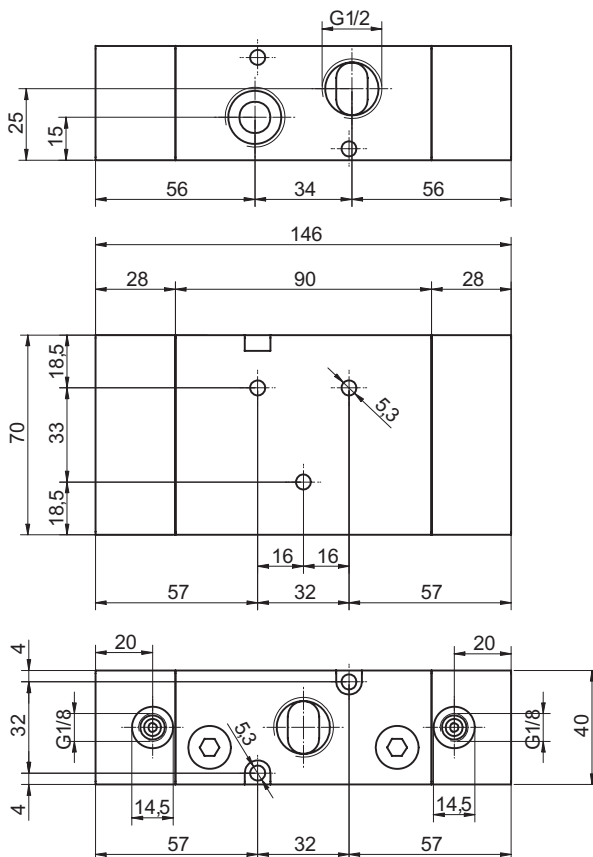

Version	Symbol	Code	Item
3/2 solenoid/solenoid		034128	A1P432